

2-Port 4K USB2.0 HDMI Dual Display KVM Switch



Overview

DM6232 is a 2 in 2 out UHD KVM switch that allows users to access to two dual HDMI interface computers via a single USB keyboard and mouse. Both input and output support HDMI2.0. With a built-in 1 USB 3.0 hub and 2.1 channel audio for rich bass surround sound. It supports superior video quality up to 4K UHD @ 60 Hz and 4K DCI @ 60Hz, displaying vivid high-definition images and providing high-quality sound effects for music, movies and games.

The DM6232 supports switch via the front panel buttons, hotkeys and mouse. With a built-in USB 3.0 hub, the KVM switch supports connection to other USB peripheral devices.

The screen dynamic synchronization display can optimize display resolution, speed up switching between systems, and ensure that the screen can be displayed normally (when switching ports, the windows opened on the extended screen will not be restored to their default setting of the main screen).

The independent (asynchronous) switching function supports switching keyboard/mouse, audio and USB HUB independently. This will eliminate the need to purchase a separate USB hub or a peripheral sharer, such as a print server, modem splitter, etc.

The DM6232 KVM switch combines Ultra HD 4K resolution, USB 3.0 hub and friendly operation to provide innovative desktop KVM switching technology.

Product Features

- A single USB keyboard and mouse controls 2 computers with dual HDMI interface.
- Supports HDMI2.0 input and output.
- Supports screen dynamic synchronization display---optimize display resolution, speed up switching between systems, and ensure that the screen can be displayed normally (when switching ports, the windows opened on the extended screen will not be restored to their default setting of the main screen).
- Supports 4K UHD (3840 x 2160 @ 60 Hz) and 4K DCI (4096 x 2160 @ 60Hz) Ultra HD resolutions.
- Computer selection via front panel buttons, keyboard hotkeys, mouse.
- Provides a USB 3.0 hub.
- Supports independent (asynchronous) switching function, which can switch the keyboard/mouse, audio and USB Hub independently.
- Compatible with HDMI 2.0, HDCP 2.2 .
- Supports HDMI audio.
- Supports high quality 2.1 channel surround system.
- Supports switching ports via mouse.
- Hot-pluggable—Add or remove computers without power down the switch.
- Automatic scanning mode for monitoring all computers.

Components
Front panel

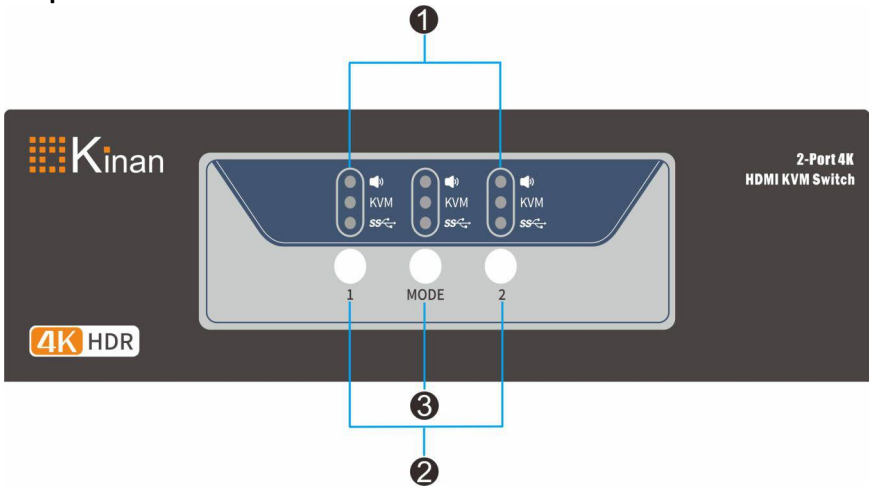

No.	Function	Description	
1	LED Status Panel	This panel contains three icons to indicate the mode and port status. And the mode and port selection buttons have three corresponding LED icons to indicate the status - KVM, audio and USB HUB.	
2	Port selection button	1	Press the button to switch to the corresponding port
		2	
3	Mode selection button	This button allows you to cycle through the four modes – All – USB HUB + KVM – Audio + KVM – KVM Long press for more than 8S to restore factory settings (Hotkey, mouse switch function, auto scan time will be restored to factory settings).	

Rear panel

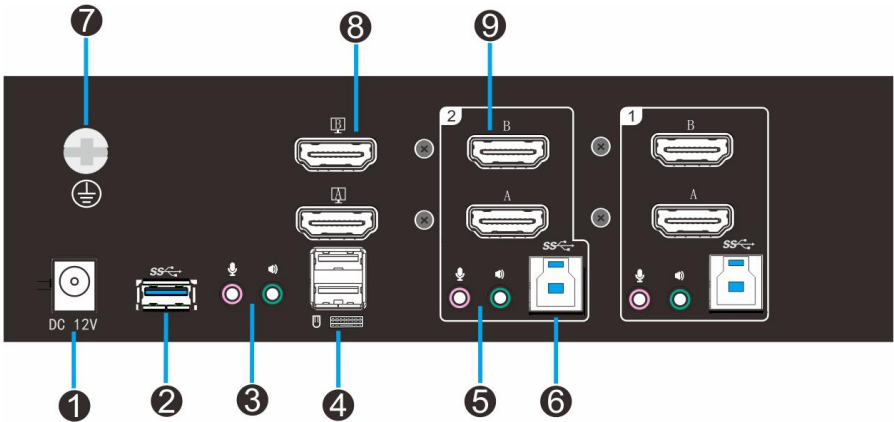

No.	Function	Description
1	Power input	Connect to the 12V power supply
2	USB3.0 interface	Plug USB peripherals (printers, scanners, drivers, etc.) into this port
3	Audio output and microphone input	Connect speaker and microphone here
4	USB HID ports	Connect USB keyboard and USB mouse
5	Audio input and microphone output	Connect the computer's audio and microphone ports
6	USB input interface	Connect the computer to the device using the USB cable
7	Grounding screw	Grounding the equipment
8	HDMI output	Connect HDMI monitor
9	HDMI input	Connect to the computer's HDMI port

Connection diagram

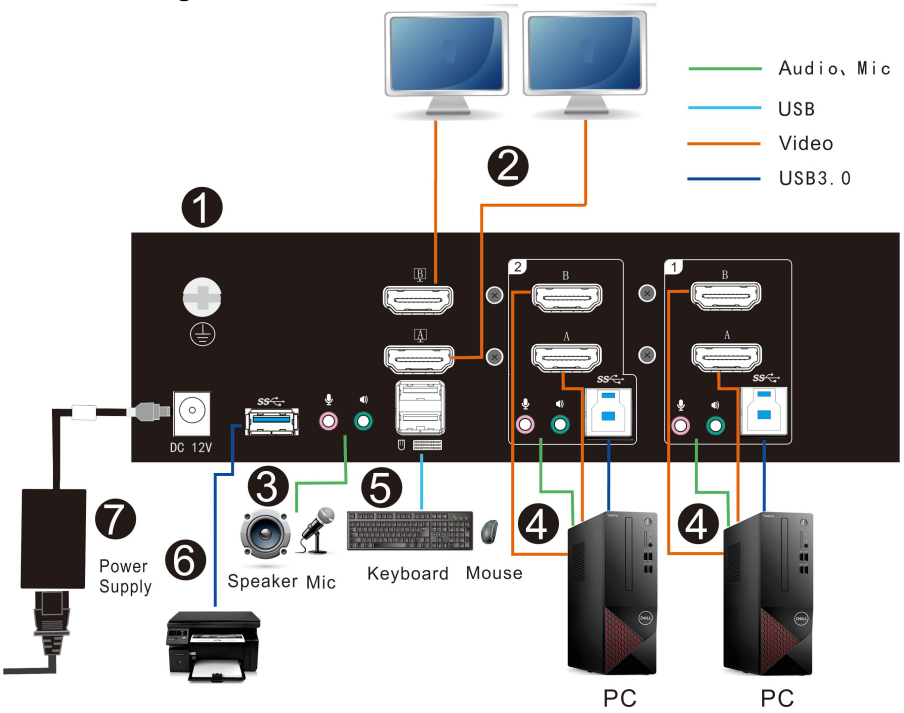

Specifications

Model		DM6232	
Computer Connections		2	
Port Selection		Pushbutton, Hotkey, Mouse	
Connectors	Console	Monitor	2x HDMI
		Keyboard/mouse	2x USB type A (White)
		Microphone (Pink)	1x 3.5mm Audio Jack
		Speaker (Green)	1x 3.5mm Audio Jack
	KVM	Video input	4x HDMI
		USB input	2x USB3.0 type B (Blue)
		Microphone (Pink)	2x 3.5mm Audio Jack
		Speaker (Green)	2x 3.5mm Audio Jack
USB3.0 port		1x USB type A (Blue)	
Switch	Menu selection	3x Buttons	
LED	Audio Mic	3x (Green)	
	KVM	3x (Green)	
	USB	3x (Green)	
Power Input		12V/ 2A	
Video Resolution		4096×2160@60Hz (4K DCI/60Hz) 3840×2160@60Hz (4K UHD/60Hz)	
Power Consumption		4W	
Environmental Requirement	Operating Temperature	0-50℃	
	Storage Temperature	-20-60℃	
	Humidity	0-80%RH, Non-condensing	
Physical Features	Material	Metal	
	Net Weight	1kg	
	Product Dimension (W×D× H)	210mmx 109.2mm x 66mm	
	Package Dimension (W×D× H)	395mmx 274mmx 110mm	